

Teileliste/ Partlist
für / for
BB - 28- 12

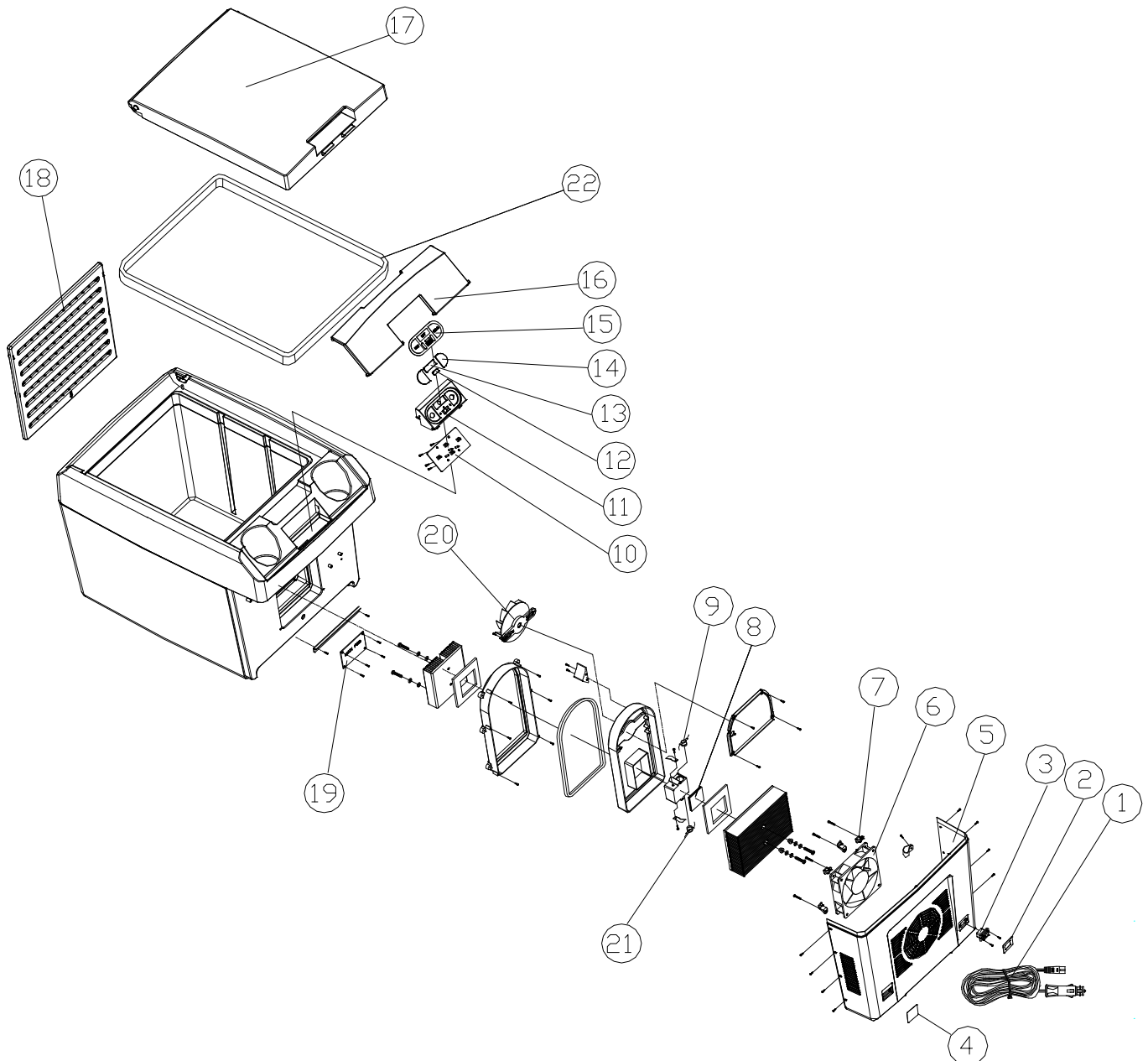

Teileliste/ Partlist
für / for
BB - 28 - 12

| Pos. Nr. | Marking in English | Bezeichnung deutsch | BB - 28 - 12 | Stück/ Piece |
|----------|-------------------------|------------------------------|------------------|--------------|
| 1 | DC Power Cord | Anschlußkabel 12/24 V | TK-280 SB | 1 |
| 2 | Label | Etikett | 53-031-INW01C | 1 |
| 3 | DC Power Socket | Anschlußbuchse 12/24 V | 33-01-1012B1 | 1 |
| 4 | Label | Etikett | 53-031-LGW01A | 1 |
| 5 | Cover | Abdeckung | 40-056-06PP8G | 1 |
| 6 | Brush Less Fan | Lüfter | 11-03-1225L12S | 1 |
| 7 | Fan Clip | Lüfterhalter | 40-92-07PO | 1 |
| 8 | Peltierelement | Peltierelement | 03-40-12705A | 1 |
| 9 | Klixon | Klixon | 13-00-CS785CTB | 1 |
| 10 | Operation PCB | Bedienungsplatine | SP-056CONPCBASA | 1 |
| 11 | Operation plate | Bedienungspanel | 40-056-15AB8F | 1 |
| 12 | Push button | Druckknöpfe | 40-056-16AB8F | 1 |
| 13 | Push button | Druckknöpfe | 40-056-17AB8F | 1 |
| 14 | Push button | Druckknöpfe | 40-056-18AB8F | 2 |
| 15 | Membrane Switch | Folientastatur | 53-056-CTW01A | 1 |
| 16 | Cover for bottle holder | Abdeckung für Flaschenhalter | 40-056-14AB8FW | 1 |
| 17 | Compl. Lid | Kompletter Deckel | SP-056COVERASB | 1 |
| 18 | Dividerwall | Trenngitter | 40-056-07AB90 | 1 |
| 19 | Main Control PCB | Hauptsteuerplatine | SP-056MAINPCBASA | 1 |
| 20 | Brush Less Fan | Lüfter | 40-C4-08PP90 | 1 |
| 21 | Klixon | Klixon | 13-00-CS7R5C | 1 |
| 22 | Lid Gasket | Deckeldichtung | 42-01-13005050 | 1 |